



User Guide



Smart Switch

Thanks for using Aztech Kyla product
If you need support or help, please visit www.kyla.aztech.com

Product Description

Smart Switch is a Zigbee wireless control switch, working together with other Zigbee devices by connecting to Zigbee Hub via Zigbee network. Easily turn on/off your lights with one touch using the Aztech Kyla App on your smartphone or tablet – anytime or anywhere.

Packing List

- Smart Switch
- User Guide
- Screw x 2

Important Safety Information

1. Neutral connection is required.
2. Not for humid places such as bathroom and greenhouse.
3. Must be used within the range of power allowable
(See page 10-11)
4. If you are unsure about the way of installation, please consult a qualified electrician.
5. The depth of switch box must not be less than 4.5cm.
6. Not for use with medical or life support equipment.

What You'll Need

1. A working Zigbee Hub



2. A slotted screwdriver and a Philips head screwdriver



3. A circuit tester

4. iOS or Android smart device and a WiFi network connection with a router

5. Download Aztech Kyla App from Google Play/App Store



Aztech Kyla App



Installation Instruction

05

1. Turn off power at the circuit breaker that controls the switch before installation. It is recommended to use a circuit tester to make sure the circuit is off.
2. Open the switch panel with slotted screwdriver.



3. Connect wires to corresponding wiring terminals as follows:

- (1) Live line to L terminal;
- (2) Neutral line to N terminal;
- (3) Load line to L1/L2/L3

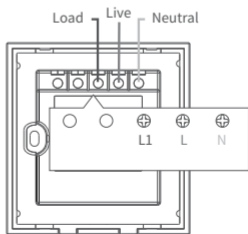

4. Double-check to confirm wirings are correct and no wire is bare.
5. Place the switch into wall and mount the screws from the existing switch.

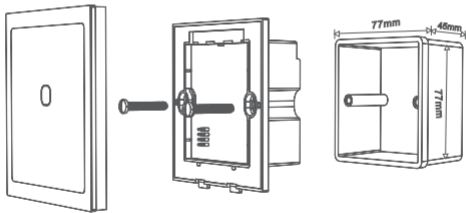

6. Press the switch panel onto the snap plate.

Configuration

1. Turn on power, the flashing LED lights show that the switch is in a state of pairing.
2. Open the Aztech Kyla App and add your smart device step by step through the App.
3. Scene settings (only for scene switches), go to the Smart Scenes in app, set scenes for the added devices. Search Scene Switch in My devices, set scenes for each button or link it to a certain smart device and set status for it.

Restore Factory Settings

Press any button on switch four times continuously, and hold on when pressing the fifth time until the blue LED light blinks quickly. Then, press any button again after 5sec to get into pairing state.

Devices in Use



Blue Light =
Switch is Off

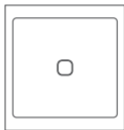

Red Light =
Switch is On

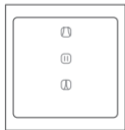

Blue Light =
Switch is Off



Red Light Flashes Once =
Scene Opens

Technical Specifications

09

Product Dimensions:	86 x 90 x 38mm
Voltage:	250V~, 50/60Hz
Alarm Sensitivity:	6% LEL \pm 3% LEL
Wireless Protocol:	Zigbee HA
Operating Temperature:	-20~60°C
Working Humidity:	\leq 80%
Operating Frequency:	2.4GHz, IEEE 802.15.4
Encryption Mode:	AES-128bit Dynamic Encryption
Transmission Distance:	60m (Open Area)

Smart 1 Gang Light Switch

Model: KSWs-111-ZB

Input: 2.4A, 250V~, 50/60Hz

Max.Load L1: 600W

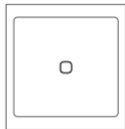

Smart 2 Gang Light Switch

Model: KSWs-112-ZB

Input: 4.8A, 250V~, 50/60Hz

Max.Load L1: 600W

Max.Load L2: 600W

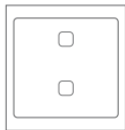

Smart 3 Gang Light Switch

Model: KSWs-113-ZB

Input: 2.4A, 250V~, 50/60Hz

Max.Load L1: 200W

Max.Load L2: 200W

Max.Load L3: 200W



Smart Dimmer Switch

Model: KSWs-121-ZB

Input: 0.6A, 250V~, 50/60Hz

Max.Load L1: 150W



Smart Scene Switch

Model: KSWs-131-ZB

Input: 0.2A, 250V~, 50/60Hz



Smart Curtain Switch

Model: KSWs-151-ZB

Input: 0.2A, 250V~, 50/60Hz

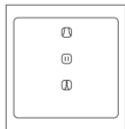

After-sales Service

1. Warranty period shall be valid for 1 year since the date of purchase (*it's subject to purchase invoice; if lost, the device's date of production shall prevail*). For any malfunction caused by inferior quality (*normal usage*), the company will repair it for you free of charge. Meanwhile, exchange of goods (*due to quality problem*) is available to you within seven days.
2. Exceptions are as follows:
 - a. Any malfunction or defect caused by improper usage conditions or environment;
 - b. Any malfunction or defect caused by improper installation, usage, unauthorized maintenance, modification, force majeure or external causes;
 - c. Any malfunction or defect resulted from applying any third-party product, software or component;
 - d. The product's warranty period expires;
 - e. Any malfunction or damage not caused by the product's design, technology and quality etc.

Aztech

©2018 Aztech Technologies Pte Ltd. All rights reserved.