

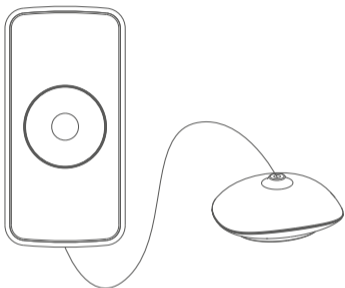

Kyla

User Guide



Smart Water Leakage Sensor

Thanks for using Aztech Kyla product
If you need support or help,
please visit www.kyla.aztech.com

Packing List

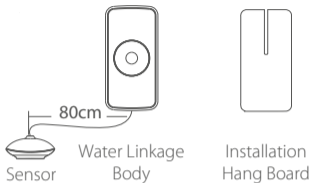

Product Description

The Smart Water Leakage Sensor has a separate design of body and sensor, efficiently protecting the product from high humidity. It adopts an ultra-low power consumption circuit design for a longer battery lifespan.

The Smart Water Leakage Sensor is applicable for hotels, basements, machine rooms, water towers, swimming pools, kitchens, bathrooms, and elsewhere a water overflow detection is needed.

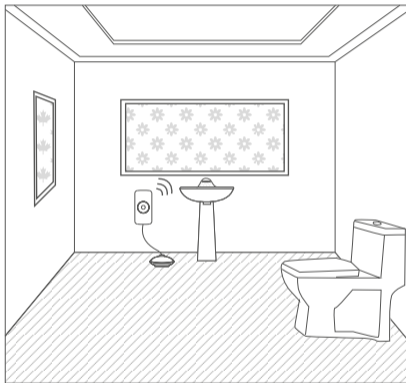

Step 1:

Download Aztech Kyla App from
Google Play/App Store



Aztech Kyla App



Step 2:

Login to Aztech Kyla App, then add "Smart Water Leakage Sensor" to device list to enable the device.

Step 3:

Remove battery insulation film to power on.

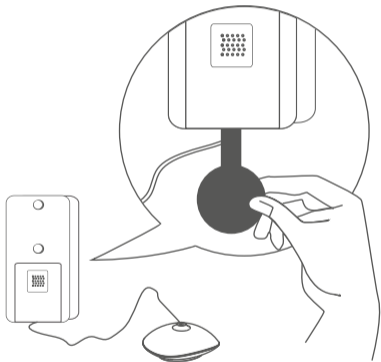

Step 4:

After following the App prompt, long press the device's networking key for 2 seconds until the green LED light flashes. App will be prompted once connected successfully.

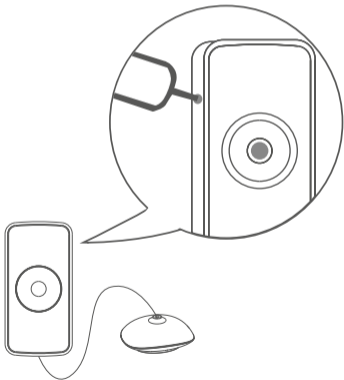

Step 5:

Tear off the gummed film and stick the equipment in the required area.

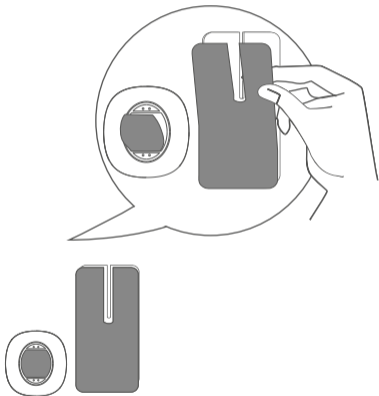

Step 6:

Insert detector body to fixed hang board.

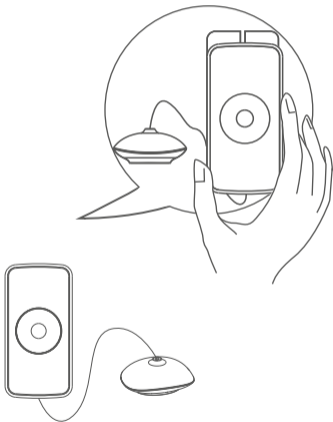

Technical Specifications

Working Voltage

DC3V (CR2032 Button Cell x 1)

Static Current

$\leq 5\mu\text{A}$

Alarm Current

$\leq 30\text{mA}$

Wireless Networking Distance

$\leq 100\text{m}$ (Open Area)

Networking Mode

Zigbee Ad-Hoc

Operating Temperature

$-10\sim 50^{\circ}\text{C}$

Working Humidity

Max 95% RH

Product Dimensions

60 x 30 x 12.5mm

Sensor Dimension

28.3 x 26.5 x 12.2mm

Notes

1. Install Smart Water Leakage Sensor at easy linking area.
2. Don't install Smart Water Leakage Sensor at areas where rainwater, lampblack, water vapor, etc., usually collect.
3. Don't install Smart Water Leakage Sensor at water immersion position.

Aztech

©2018 Aztech Technologies Pte Ltd.
All rights reserved.